

2007 Jeep Wrangler (JK)

Replacement Control Arms



READ AND UNDERSTAND ALL INSTRUCTIONS AND WARNINGS PRIOR TO INSTALLATION OF SYSTEM AND OPERATION OF VEHICLE.

SAFETY WARNING

BDS Suspension Co. recommends this system be installed by a professional technician. In addition to these instructions, professional knowledge of disassembly/ reassembly procedures and post installation checks must be known.

PRODUCT SAFETY WARNING

Certain BDS Suspension products are intended to improve off-road performance. Modifying your vehicle for off-road use may result in the vehicle handling differently than a factory equipped vehicle. Extreme care must be used to prevent loss of control or vehicle rollover. Failure to drive your modified vehicle safely may result in serious injury or death. BDS Suspension Co. does not recommend the combined use of suspension lifts, body lifts, or other lifting devices.

You should never operate your modified vehicle under the influence of alcohol or drugs. Always drive your modified vehicle at reduced speeds to ensure your ability to control your vehicle under all driving conditions. Always wear your seat belt.

PRE-INSTALLATION NOTES

1. Special literature required: OE Service Manual for model/year of vehicle. Refer to manual for proper disassembly/reassembly procedures of OE and related components.
2. Adhere to recommendations when replacement fasteners, retainers and keepers are called out in the OE manual.
3. Larger rim and tire combinations may increase leverage on suspension, steering, and related components. When selecting combinations larger than OE, consider the additional stress you could be inducing on the OE and related components.

4. Post suspension system vehicles may experience drive line vibrations. Angles may require tuning, slider on shaft may require replacement, shafts may need to be lengthened or trued, and U-joints may need to be replaced.
5. Secure and properly block vehicle prior to installation of BDS Suspension components. Always wear safety glasses when using power tools.
6. If installation is to be performed without a hoist, BDS Suspension Co. recommends rear alterations first.
7. Due to payload options and initial ride height variances, the amount of lift is a base figure. Final ride height dimensions may vary in accordance to original vehicle attitude. Always measure the attitude prior to beginning installation.

POST-INSTALLATION WARNINGS

1. Check all fasteners for proper torque. Check to ensure for adequate clearance between all rotating, mobile, fixed, and heated members. Verify clearance between exhaust and brake lines, fuel lines, fuel tank, floor boards and wiring harness. Check steering gear for clearance. Test and inspect brake system.
2. Perform steering sweep to ensure front brake hoses have adequate slack and do not contact any rotating, mobile or heated members. Inspect rear brake hoses at full extension for adequate slack. Failure to perform hose check/ replacement may result in component failure. Longer replacement hoses, if needed can be purchased from a local parts supplier.
3. Perform head light check and adjustment.
4. Re-torque all fasteners after 500 miles. Always inspect fasteners and components during routine servicing.

102 S. Michigan Avenue • Coldwater, MI 49036
517-279-2135 • www.bds-suspension.com

Installation Instructions

1. Park vehicle on clean flat surface. Block wheels for safety.
2. Raise vehicle and support frame with jack stands.
3. Support axle with hydraulic jack.
4. Remove control arm that is to be replaced. Work on one side of the vehicle at a time. Retain hardware.
5. Install replacement control arm (Fig 1, 2, or 3) with OE hardware. It may be necessary to raise or lower the axle to get the sleeves in the arm to line up with the OE mounting points. If installing optional arm with flex eye or adjustable end. The flex eye or adjustable end will go into the frame mount.
6. Repeat instructions for opposite side.
7. Lower vehicle and bounce to settle suspension.
8. Tighten control arm hardware as follows: 12mm hardware (Front upper arms – only): 65 ft-lbs, 14mm hardware (Front / Rear Lower, Rear Upper): 110 ft-lbs.
9. Perform a steering sweep check. Check for possible interference. The steering stops may need to be adjusted slightly.
10. Recheck all fasteners for proper torque after 500 miles and at regularly scheduled maintenance intervals.

Adjustable Arm Lengths (4-1/2" kit):

Front Upper	18-5/8"	Rear Upper	18-1/8"
Front Lower	23-3/16"	Rear Lower	20-1/2"

Note: The above lengths are approximate and may need to be adjusted to correct pinion / caster angles.

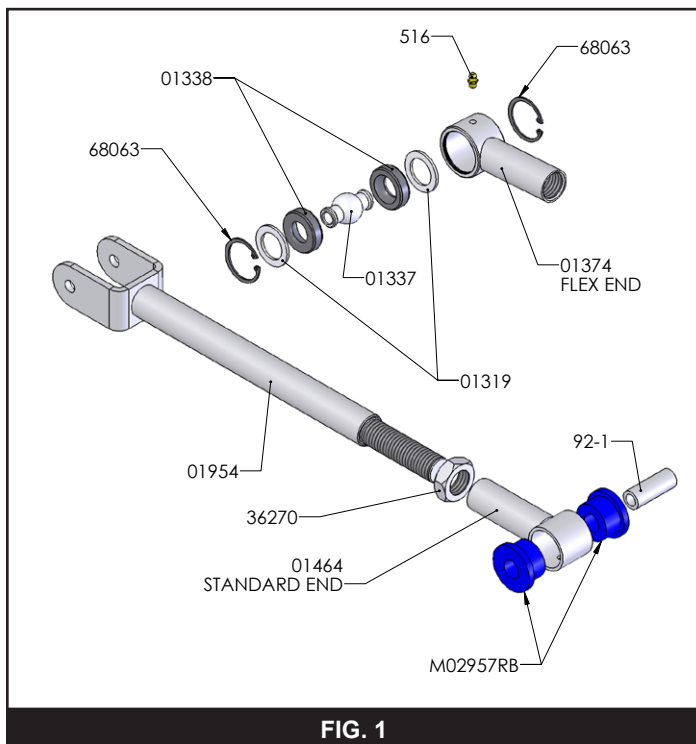

FIG. 1

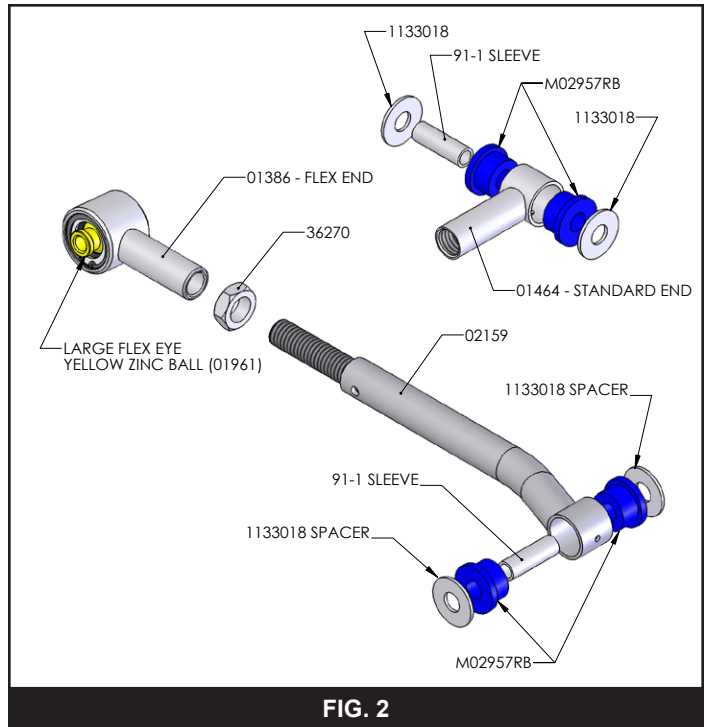

FIG. 2

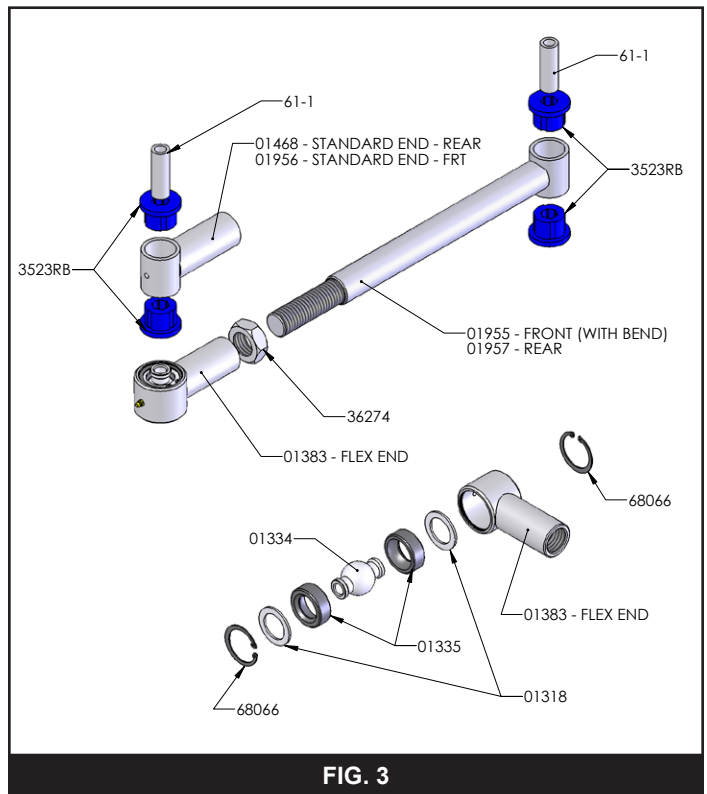

FIG. 3